

Beacons and indicator banks

Beacons and indicator banks Ø 70 mm Universal, Harmony type **XVB**

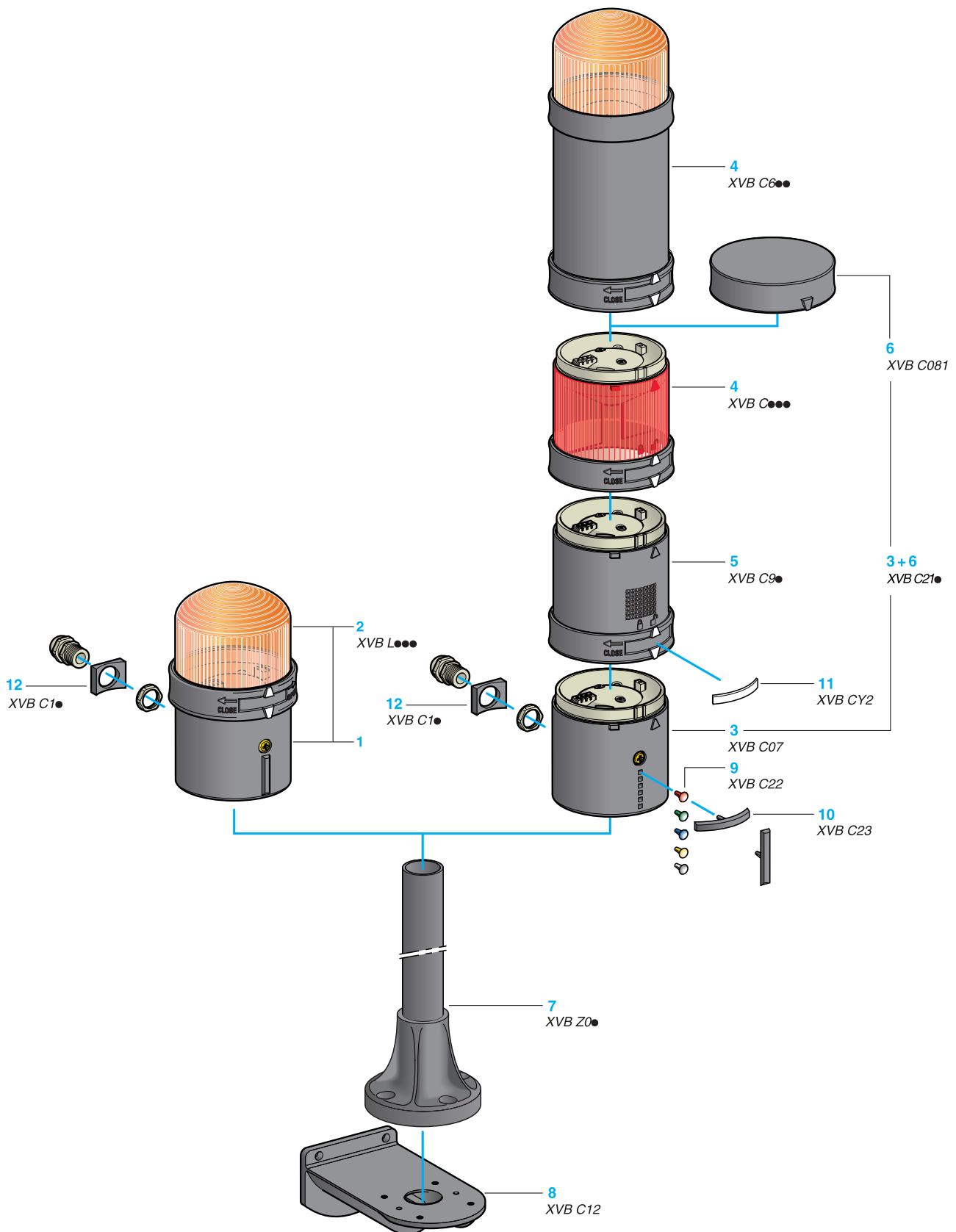

Beacons and indicator banks

Beacons and indicator banks Ø 70 mm Universal, Harmony type XVB

Beacons and indicator banks XVB are visual or audible signalling units and are mainly used for indicating, throughout 360° and at a distance, the various states or operation sequences of a machine or installation.
Examples: start, stop machine, no material, call technical staff, fault signalling, etc.

Illuminated beacon

Complete product

Ready assembled with a single illuminated signalling unit:
☐ steady light (with incandescent bulb or LED),
☐ flashing light (with incandescent bulb or LED), or
☐ "flash" (with discharge tube).

The beacon comprises:

- 1 A base unit with a removable terminal block and bottom or side cable entry.
- 2 One coloured illuminated unit (green, red, orange, blue, clear or yellow).

Indicator bank

Customer assembled product

Variable composition assembly of 1 to 5 illuminated or audible units which are supplied as separate items (assembly by user).

The bank comprises:

- 3 A base unit with a removable terminal block and bottom or side cable entry.
- 4 1 to 5 coloured illuminated units (green, red, orange, blue, clear or yellow).
Maximum configuration: 5 units or 4 units + 1 "flash".
- 5 Or 1 or 2 audible units.
- 6 A top cover (except when using a "flash" discharge tube).

■ The illuminated or audible units stack vertically and are easily locked and unlocked using an integral clamping ring. Electrical connections between each unit are made automatically.

■ Only one "flash" discharge tube unit can be fitted on each indicator bank and it is always mounted on top.

■ Connection on the AS-Interface cabling system is possible by ordering a dedicated base unit. Please refer to our "AS-Interface cabling system" catalogue.

Accessories

For beacons and indicator banks

- 7 Fixing base comprising a support tube glued into a plastic fixing plate, for heights beneath the base unit of 80, 380 or 780 mm.
- 8 Fixing plate for mounting on vertical support.
- 9 Coloured markers (1).
- 10 Legend holder with legend (1).
- 11 Legends that attach to locking ring of each signalling unit for identification.
- 12 Adaptor and 13P cable gland.

(1) These enable the position of the various units (illuminated or audible) to be identified in the event of dismantling the bank.

Installation

Mounting

- Base unit fixed directly onto panel using 2 screws.
- Fixed using a fixing base comprising an aluminium support tube glued into a plastic fixing plate.

Cabling

By means of removable terminal block incorporated in base unit (simplified wiring). The screw and captive cable clamp terminals are protected to prevent any accidental contact with live parts.

Beacons and indicator banks

Beacons and indicator banks Ø 70 mm Universal,
Harmony type XVB

Environment characteristics

Product certifications	Standard version		CSA, UL, CCC
Conformity to standards			IEC/EN 60947-5-1
Protective treatment	Standard version		"TC"
Ambient air temperature	For storage	°C	- 40...+ 70
	For operation (1)	°C	Illuminated units with steady light signalling: - 25...+ 70, with 7 W incandescent bulb - 25...+ 50, with LED
		°C	Illuminated units with flashing light signalling: - 25...+ 50, with 7 W incandescent bulb - 25...+ 50, with LED
		°C	Illuminated units with "flash" discharge tube: - 25...+ 50
		°C	Audible units: - 25...+ 50, with buzzer
Electric shock protection Conforming to IEC 536	Mounted on support tube		Class I
	Mounted on base unit		Class II
Degree of protection	Conforming to IEC 60529 and NF C 20-010		IP 65 (mounted on fixing base XVB Z0●) IP 66 (mounted directly on base unit)
	Conforming to UL 508		Type 4X NEMA "Indoor"
Material	Illuminated units		Polycarbonate
	Base unit and cover		Glass-reinforced polyamide and polycarbonate
	Support tube		Painted aluminium
	Fixing plate		Zamak

(1) Warning: illuminated units with incandescent bulbs must not be combined with LED illuminated units, due to the risk of overheating.
Also, when different units (e.g. steady, flashing...) are combined, the maximum temperature is limited to that of the weaker unit.

Electrical characteristics			
Rated insulation voltage (Ui)	Conforming to IEC 60947-1	V	250
Voltage limits	Conforming to IEC 60947-5-1	V	0.85 to 1.10 Un (Un: nominal voltage)
Consumption	LED units	mA	Steady light signalling: ≈ 24 V: < 30 ~ 120...230 V: < 30
		mA	Flashing light signalling: ≈ 24 V: < 40 ~ 120...230 V: < 15
	Units with discharge tube (1)	mA	Flashing light signalling: ≈ 24 V: 5 J unit: < 430; 10 J unit: < 850 ~ 120 V: 5 J unit: < 130; 10 J unit: < 260 ~ 230 V: 5 J unit: < 105; 10 J unit: < 210
	Audible units	mA	≈ 12...48 V: < 20 V ~ 120...230 V: < 50
Rated impulse withstand voltage	Conforming to IEC 60947-1	kV	U imp = 4
Light source	Illuminated units with steady or flashing light signalling		LEDs: degree of pollution 2 Bulbs with BA 15d base fitting, maximum power 7 W
Illuminating power	Units with discharge tube	cds	13 (integral high intensity tube) with clear lens unit: 5 J tube 26 (integral high intensity tube) with clear lens unit: 10 J tube
Audible unit	Continuous or intermittent tone	dB	90 at 1 m
	Fundamental frequency	kHz	2.8
Terminal referencing			1 terminal referenced "C" common to all 5 units
			1 or 5 terminals referenced 1 to 5, depending on number of units
Connection	Maximum clamping capacity on protected, ready-to-tighten, screw and captive cable clamp terminals	mm ²	1 x 1.5 with cable end
Frequency of illuminated units	Illuminated units with flashing light signalling	Hz	1
	Illuminated units with discharge tube	Hz	1

(1) **Warning:** illuminated units with a flash discharge tube are not suitable for steady light signalling due to the heat generated.

Beacons and indicator banks

Illuminated beacons Ø 70 mm Universal,
Harmony type XVB L

For incandescent bulbs or LEDs (BA 15d base fitting)



XVB L3●



XVB L4B●

Illuminated beacons with steady light signalling

Description	Light source, to be ordered separately (1)	Colour	Reference	Weight kg
Complete unit comprising: - 1 illuminated unit - 1 base unit (direct or tube fixing)	Incandescent bulb 7 W max. 250 V max.	Green	XVB L33	0.260
		Red	XVB L34	0.260
		Orange	XVB L35	0.260
		Blue	XVB L36	0.260
		Clear	XVB L37	0.260
		Yellow	XVB L38	0.260

Illuminated beacons with integral flashing light signalling

Description	Light source, to be ordered separately (1)	Colour	Reference	Weight kg
Complete unit comprising: - 1 illuminated unit - 1 base unit (direct or tube fixing)	Incandescent bulb 7 W max. ~ 24 V --- 24...48 V	Green	XVB L4B3	0.280
		Red	XVB L4B4	0.280
		Orange	XVB L4B5	0.280
		Blue	XVB L4B6	0.280
		Clear	XVB L4B7	0.280
		Yellow	XVB L4B8	0.280
		Green	XVB L4M3	0.280
		Red	XVB L4M4	0.280
	Incandescent bulb 7 W max. ~ 48...230 V	Orange	XVB L4M5	0.280
		Blue	XVB L4M6	0.280
		Clear	XVB L4M7	0.280
		Yellow	XVB L4M8	0.280

(1) Incandescent bulbs and LEDs, see page 35081/11.

Beacons and indicator banks

Illuminated beacons Ø 70 mm Universal,
Harmony type XVB L
With LED light source



XVB L0B●

Illuminated beacons with steady light signalling

Description	Light source	Colour	Reference	Weight kg
Complete unit comprising: - 1 cover - 1 illuminated unit - 1 base unit (direct or tube fixing)	LED, included ~ 24 V	Green	XVB L0B3	0.270
		Red	XVB L0B4	0.270
		Orange	XVB L0B5	0.270
		Blue	XVB L0B6	0.270
		Clear	XVB L0B7	0.270
		Yellow	XVB L0B8	0.270
	LED, included ~ 120 V	Green	XVB L0G3	0.270
		Red	XVB L0G4	0.270
		Orange	XVB L0G5	0.270
		Blue	XVB L0G6	0.270
		Clear	XVB L0G7	0.270
		Yellow	XVB L0G8	0.270
	LED, included ~ 230 V	Green	XVB L0M3	0.270
		Red	XVB L0M4	0.270
		Orange	XVB L0M5	0.270
		Blue	XVB L0M6	0.270
		Clear	XVB L0M7	0.270
		Yellow	XVB L0M8	0.270



XVB L1B●

Illuminated beacons with integral flashing light signalling

Description	Light source	Colour	Reference	Weight kg
Complete unit comprising: - 1 cover - 1 illuminated unit - 1 base unit (direct or tube fixing)	LED, included ~ 24 V	Green	XVB L1B3	0.280
		Red	XVB L1B4	0.280
		Orange	XVB L1B5	0.280
		Blue	XVB L1B6	0.280
		Clear	XVB L1B7	0.280
		Yellow	XVB L1B8	0.280
	LED, included ~ 120 V	Green	XVB L1G3	0.280
		Red	XVB L1G4	0.280
		Orange	XVB L1G5	0.280
		Blue	XVB L1G6	0.280
		Clear	XVB L1G7	0.280
		Yellow	XVB L1G8	0.280
	LED, included ~ 230 V	Green	XVB L1M3	0.280
		Red	XVB L1M4	0.280
		Orange	XVB L1M5	0.280
		Blue	XVB L1M6	0.280
		Clear	XVB L1M7	0.280
		Yellow	XVB L1M8	0.280

Beacons and indicator banks

Illuminated beacons Ø 70 mm Universal,
Harmony type XVB L
With “flash” discharge tube



XVB L6B●



XVB L8B●

Illuminated beacons with 5 Joule “flash” discharge tube

Description	Light source	Colour	Reference	Weight kg
Complete unit comprising: - 1 cover - 1 illuminated unit - 1 base unit (direct or tube fixing)	Integral “flash” discharge tube ≈ 24 V	Green	XVB L6B3	0.440
		Red	XVB L6B4	0.440
		Orange	XVB L6B5	0.440
		Blue	XVB L6B6	0.440
		Clear	XVB L6B7	0.440
		Yellow	XVB L6B8	0.440
	Integral “flash” discharge tube ~ 120 V	Green	XVB L6G3	0.425
		Red	XVB L6G4	0.425
		Orange	XVB L6G5	0.425
		Blue	XVB L6G6	0.425
		Clear	XVB L6G7	0.425
		Yellow	XVB L6G8	0.425
	Integral “flash” discharge tube ~ 230 V	Green	XVB L6M3	0.435
		Red	XVB L6M4	0.435
		Orange	XVB L6M5	0.435
		Blue	XVB L6M6	0.435
		Clear	XVB L6M7	0.435
		Yellow	XVB L6M8	0.435

Illuminated beacons with 10 Joule “flash” discharge tube

Description	Light source	Colour	Reference	Weight kg
Complete unit comprising: - 1 cover - 1 illuminated unit - 1 base unit (direct or tube fixing)	Integral “flash” discharge tube ≈ 24 V	Green	XVB L8B3	0.450
		Red	XVB L8B4	0.450
		Orange	XVB L8B5	0.450
		Blue	XVB L8B6	0.450
		Clear	XVB L8B7	0.450
		Yellow	XVB L8B8	0.450
	Integral “flash” discharge tube ~ 120 V	Green	XVB L8G3	0.460
		Red	XVB L8G4	0.460
		Orange	XVB L8G5	0.460
		Blue	XVB L8G6	0.460
		Clear	XVB L8G7	0.460
		Yellow	XVB L8G8	0.460
	Integral “flash” discharge tube ~ 230 V	Green	XVB L8M3	0.460
		Red	XVB L8M4	0.460
		Orange	XVB L8M5	0.460
		Blue	XVB L8M6	0.460
		Clear	XVB L8M7	0.460
		Yellow	XVB L8M8	0.460

For use with base unit XVB C●●: see page 35081/10

Beacons and indicator banks

Indicator banks Ø 70 mm Universal,
Harmony type XVB C (for customer assembly, up to 5 units)
Illuminated units for incandescent bulbs or LEDs
(BA 15d base fitting)



XVB C3●



XVB C4●●

Illuminated units with steady light signalling

Description	Light source, to be ordered separately (1)	Colour	Reference	Weight kg
Illuminated units	Incandescent bulb 7 W max. 250 V max. or LED	Green	XVB C33	0.140
		Red	XVB C34	0.140
		Orange	XVB C35	0.140
		Blue	XVB C36	0.140
		Clear	XVB C37	0.140
		Yellow	XVB C38	0.140

Illuminated units with integral flashing light signalling

Description	Light source, to be ordered separately (1)	Colour	Reference	Weight kg
Illuminated units	Incandescent bulb 7 W max. ~ 24 V = 24...48 V or LED	Green	XVB C4B3	0.160
		Red	XVB C4B4	0.160
		Orange	XVB C4B5	0.160
		Blue	XVB C4B6	0.160
		Clear	XVB C4B7	0.160
		Yellow	XVB C4B8	0.160
	Incandescent bulb 7 W max. ~ 48...230 V or LED	Green	XVB C4M3	0.160
		Red	XVB C4M4	0.160
		Orange	XVB C4M5	0.160
		Blue	XVB C4M6	0.160
		Clear	XVB C4M7	0.160
		Yellow	XVB C4M8	0.160

(1) Incandescent bulbs and LEDs, see page 35081/11.

For use with base unit XVB C●●: see page 35081/10

Beacons and indicator banks

Indicator banks Ø 70 mm Universal,
Harmony type XVB C (for customer assembly, up to 5 units)
Illuminated units with integral LED



XVB C2●●



XVB C5●●

Illuminated units with steady light signalling

Description	Voltage	Colour	Reference	Weight kg
Illuminated units with integral LED	≈ 24 V	Green	XVB C2B3	0.150
		Red	XVB C2B4	0.150
		Orange	XVB C2B5	0.150
		Blue	XVB C2B6	0.150
		Clear	XVB C2B7	0.150
		Yellow	XVB C2B8	0.150
	~ 120 V	Green	XVB C2G3	0.150
		Red	XVB C2G4	0.150
		Orange	XVB C2G5	0.150
		Blue	XVB C2G6	0.150
		Clear	XVB C2G7	0.150
		Yellow	XVB C2G8	0.150
	~ 230 V	Green	XVB C2M3	0.150
		Red	XVB C2M4	0.150
		Orange	XVB C2M5	0.150
		Blue	XVB C2M6	0.150
		Clear	XVB C2M7	0.150
		Yellow	XVB C2M8	0.150

Illuminated units with integral flashing light signalling

Description	Voltage	Colour	Reference	Weight kg
Illuminated units with integral LED	≈ 24 V	Green	XVB C5B3	0.170
		Red	XVB C5B4	0.170
		Orange	XVB C5B5	0.170
		Blue	XVB C5B6	0.170
		Clear	XVB C5B7	0.170
		Yellow	XVB C5B8	0.170
	~ 120 V	Green	XVB C5G3	0.170
		Red	XVB C5G4	0.170
		Orange	XVB C5G5	0.170
		Blue	XVB C5G6	0.170
		Clear	XVB C5G7	0.170
		Yellow	XVB C5G8	0.170
	~ 230 V	Green	XVB C5M3	0.170
		Red	XVB C5M4	0.170
		Orange	XVB C5M5	0.170
		Blue	XVB C5M6	0.170
		Clear	XVB C5M7	0.170
		Yellow	XVB C5M8	0.170

Beacons and indicator banks

Indicator banks Ø 70 mm Universal,
Harmony type XVB C (for customer assembly, up to 5 units)
Illuminated units with integral “flash” discharge tube



XVB C6●●



XVB C8●●

Illuminated units with 5 Joule “flash” discharge tube

Description	Light source	Colour	Reference	Weight kg
Illuminated units	Integral “flash” discharge tube ≈ 24 V	Green	XVB C6B3	0.295
		Red	XVB C6B4	0.295
		Orange	XVB C6B5	0.295
		Blue	XVB C6B6	0.295
		Clear	XVB C6B7	0.295
		Yellow	XVB C6B8	0.295
	Integral “flash” discharge tube ~ 120 V	Green	XVB C6G3	0.280
		Red	XVB C6G4	0.280
		Orange	XVB C6G5	0.280
		Blue	XVB C6G6	0.280
		Clear	XVB C6G7	0.280
		Yellow	XVB C6G8	0.280
	Integral “flash” discharge tube ~ 230 V	Green	XVB C6M3	0.290
		Red	XVB C6M4	0.290
		Orange	XVB C6M5	0.290
		Blue	XVB C6M6	0.290
		Clear	XVB C6M7	0.290
		Yellow	XVB C6M8	0.290

Illuminated units with 10 Joule “flash” discharge tube

Description	Light source	Colour	Reference	Weight kg
Illuminated units	Integral “flash” discharge tube ≈ 24 V	Green	XVB C8B3	0.305
		Red	XVB C8B4	0.305
		Orange	XVB C8B5	0.305
		Blue	XVB C8B6	0.305
		Clear	XVB C8B7	0.305
		Yellow	XVB C8B8	0.305
	Integral “flash” discharge tube ~ 120 V	Green	XVB C8G3	0.315
		Red	XVB C8G4	0.315
		Orange	XVB C8G5	0.315
		Blue	XVB C8G6	0.315
		Clear	XVB C8G7	0.315
		Yellow	XVB C8G8	0.315
	Integral “flash” discharge tube ~ 230 V	Green	XVB C8M3	0.315
		Red	XVB C8M4	0.315
		Orange	XVB C8M5	0.315
		Blue	XVB C8M6	0.315
		Clear	XVB C8M7	0.315
		Yellow	XVB C8M8	0.315

Beacons and indicator banks

Indicator banks Ø 70 mm Universal,
Harmony type XVB C (for customer assembly, up to 5 units)
Audible units, base units, cover, accessories

Audible units				
Description	Characteristics	Reference	Weight kg	
Buzzer, 90 dB at 1 m Adjustable: - 70 or 90 dB - continuous or intermittent tone using microswitch	≈ 12...48 V ~ 120...230 V	XVB C9B XVB C9M	0.170 0.180	
Base units (for direct or tube fixing)				
Description	For use with	Type	Reference	Weight kg
Base unit + cover with bottom or side cable entry	Banks without "flash" discharge tube unit	Standard	XVB C21	0.190
Base unit only with bottom or side cable entry	Banks with "flash" discharge tube unit	Standard	XVB C07	0.160
Base unit + cover with side cable entry	All types of bank	AS-Interface (1)	XVB C21A	—
Base unit + cover with bottom entry, pre-cabled (length 1 metre) and fitted with M12 end connector	All types of bank	AS-Interface (1)	XVB C21B	—
(1) For further information on AS-Interface connections, refer to our "AS-Interface cabling system" catalogue.				
Accessories common to beacons and indicator banks				
Description	Height under base unit mm	Colour	Reference	Weight kg
Fixing bases comprising: Ø 25 mm aluminium support tube glued into black plastic fixing plate	80	Black aluminium	XVB Z02	0.110
		Aluminium	XVB Z02A	0.110
	380	Black aluminium	XVB Z03	0.200
		Aluminium	XVB Z03A	0.200
	780	Black aluminium	XVB Z04	0.325
		Aluminium	XVB Z04A	0.325
Description	For use with	Material	Reference	Weight kg
Fixing plate for use on horizontal support	Ø 25 mm aluminium support tube (to be glued into plastic fixing plate)	Plastic	XVB Z01	0.050
Fixing plate for use on vertical support	Base unit (direct mounting), fixing plate XVB Z01 or fixing bases XVB Z0●	Zamak	XVB C12	0.380

Beacons and indicator banks

Beacons and indicator banks Ø 70 mm

Universal, Harmony type XVB

Accessories

Accessories common to beacons and indicator banks (continued)

Description	Characteristics		Sold in lots of	Unit reference	Weight kg
Incandescent bulbs BA 15d base fitting	12 V	7 W	10	DL1 BEJ	0.090
	24 V	6.5 W	10	DL1 BEB	0.090
	48 V	6 W	10	DL1 BEE	0.090
	120 V	7 W	10	DL1 BEG	0.090
	230 V	7 W	10	DL1 BEM	0.090
LEDs BA 15d base fitting 	24 V	White	1	DL1 BDB1	0.015
		Green	1	DL1 BDB3	0.015
		Red	1	DL1 BDB4	0.015
		Orange	1	DL1 BDB5	0.015
		Blue	1	DL1 BDB6	0.015
		Yellow	1	DL1 BDB8	0.015
	120 V	White	1	DL1 BDG1	0.015
		Green	1	DL1 BDG3	0.015
		Red	1	DL1 BDG4	0.015
		Orange	1	DL1 BDG5	0.015
		Blue	1	DL1 BDG6	0.015
		Yellow	1	DL1 BDG8	0.015
	230 V	White	1	DL1 BDM1	0.015
		Green	1	DL1 BDM3	0.015
		Red	1	DL1 BDM4	0.015
		Orange	1	DL1 BDM5	0.015
		Blue	1	DL1 BDM6	0.015
		Yellow	1	DL1 BDM8	0.015
Flashing LEDs BA 15d base fitting 	24 V	White	1	DL1 BKB1	0.015
		Green	1	DL1 BKB3	0.015
		Red	1	DL1 BKB4	0.015
		Orange	1	DL1 BKB5	0.015
		Blue	1	DL1 BKB6	0.015
		Yellow	1	DL1 BKB8	0.015
	120 V	White	1	DL1 BKG1	0.015
		Green	1	DL1 BKG3	0.015
		Red	1	DL1 BKG4	0.015
		Orange	1	DL1 BKG5	0.015
		Blue	1	DL1 BKG6	0.015
		Yellow	1	DL1 BKG8	0.015
	230 V	White	1	DL1 BKM1	0.015
		Green	1	DL1 BKM3	0.015
		Red	1	DL1 BKM4	0.015
		Orange	1	DL1 BKM5	0.015
		Blue	1	DL1 BKM6	0.015
		Yellow	1	DL1 BKM8	0.015

Accessories specific to indicator banks

Description	Characteristics	Sold in lots of	Unit reference	Weight kg
Cover only	—	—	XVB C081	0.030
Set of coloured markers	6 colours	—	XVB C22	0.001
Set of 5 legend holders	Identification of stacked units on base unit	—	XVB C23	0.002
Sheet of 85 legends for base unit legend holder (XVB C23)	Identification of stacked units on base unit	—	XVB CY1	0.005
Sheet of 52 legends	Identification of stacked units on locking ring	—	XVB CY2	0.005
Adaptor for side entry through base unit	With 13P cable gland	1	XVB C14	0.015
SIS labelling software creation of legends	For English, French, German, Italian and Spanish	—	XBY 2U	0.100

Beacons and indicator banks

Beacons and indicator banks Ø 70 mm
Universal, Harmony type XVB

Dimensions

Illuminated beacons XVB L●●●

For BA 15d bulb or LED

With "flash" discharge tube unit

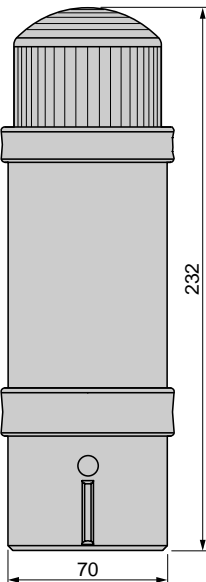
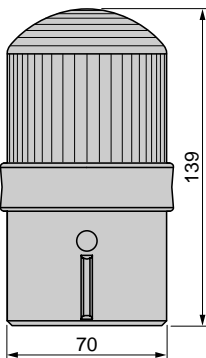

Indicator banks XVB C●●●

Without "flash" discharge tube unit

With "flash" discharge tube unit

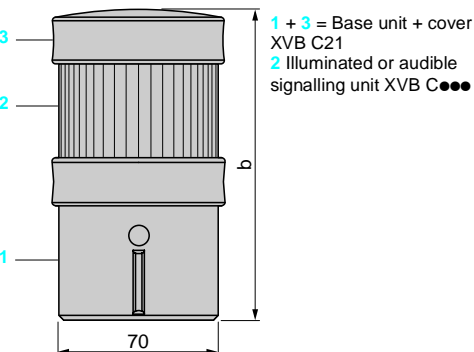

Number of illuminated or audible signalling units (no "flash")	b
1	138
2	201
3	264
4	327
5	390

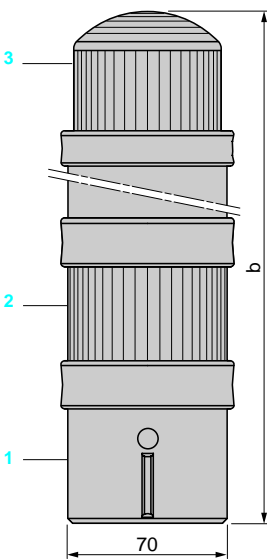

- 1 Base unit XVB C07
- 2 Illuminated or audible signalling unit XVB C●●●
- 3 "Flash" unit XVB C●●●

Number of illuminated or audible signalling units other than "flash" tube	b
1	295
2	358
3	421
4	484

Panel cut-out for direct fixing

On base unit XVB C21, XVB C07, XVB C21A or XVB C21B

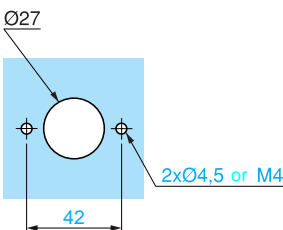

Dimensions

With fixing bases comprising XVB Z0● (aluminium support tube glued into black plastic fixing plate)

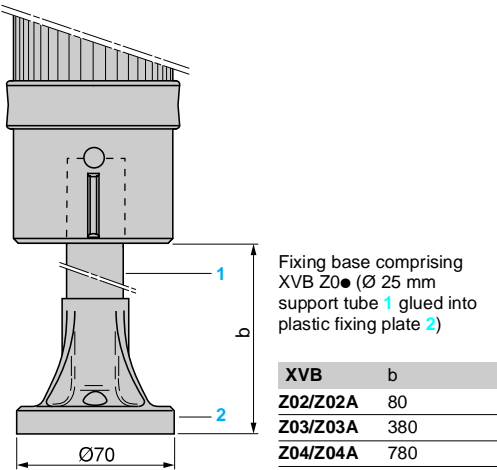

Fixing base comprising XVB Z0● (Ø 25 mm support tube 1 glued into plastic fixing plate 2)

XVB	b
Z02/Z02A	80
Z03/Z03A	380
Z04/Z04A	780

Horizontal support panel cut-out for mounting on fixing plate

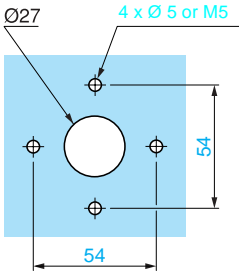

With fixing plate XVB C12 for use on vertical support

Direct mounting on base unit

Mounting using fixing base XVB Z0● (aluminium support tube glued into black plastic fixing plate)

Vertical support panel drillings for mounting fixing plate XVB C12

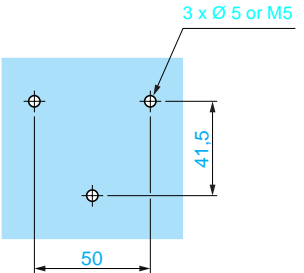
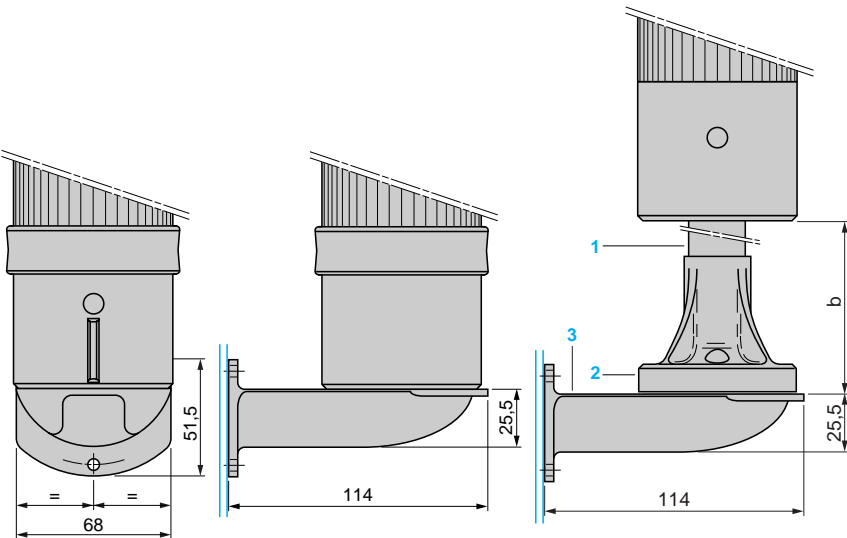

Fixing base comprising XVB Z0● (Ø 25 mm support tube 1 glued into plastic fixing plate 2) mounted on fixing plate XVB C12 for vertical support 3

XVB	b
Z02/Z02A	80
Z03/Z03A	380
Z04/Z04A	780

Installation

Connections

XVB L

XVB C

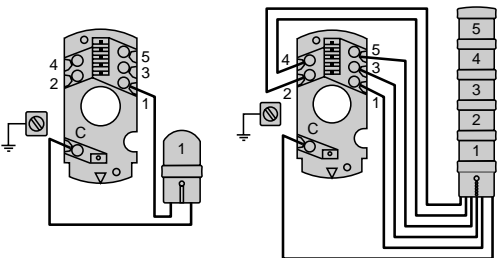

Adjustment of audible signal for buzzers type XVB C9●

- By means of 4 microswitches located in the base of the buzzer:
- 2 switches marked 1 and 2 for selecting continuous or intermittent mode (Hz).
 - 2 switches marked 3 and 4 for selecting the power (dB) of the audible signal.

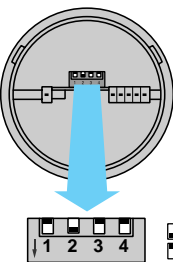

Position of microswitches		Setting
1	2	Mode
1	1	— 2.8 kHz
1	0	— 2.8 kHz
0	1	⎓ 5 Hz (1)
0	0	⎓ 1 Hz
3	4	Power
1	1	90 dB (1)
0	1	85 dB
1	0	80 dB
0	0	70 dB

(1) Factory setting.

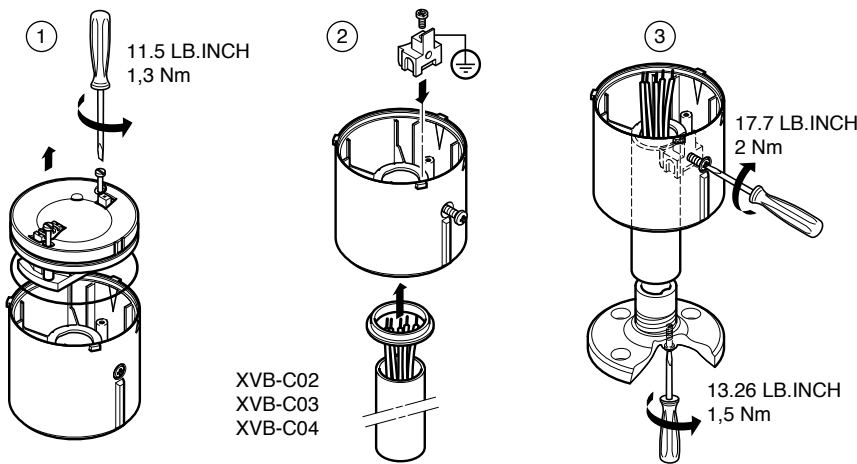
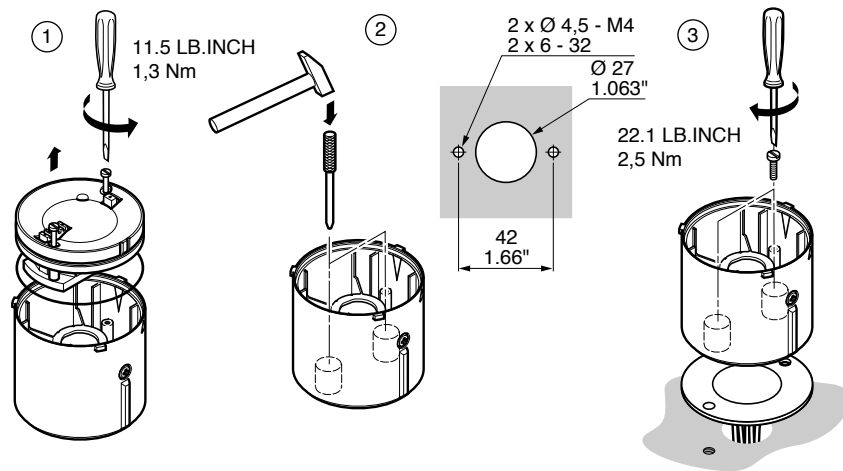
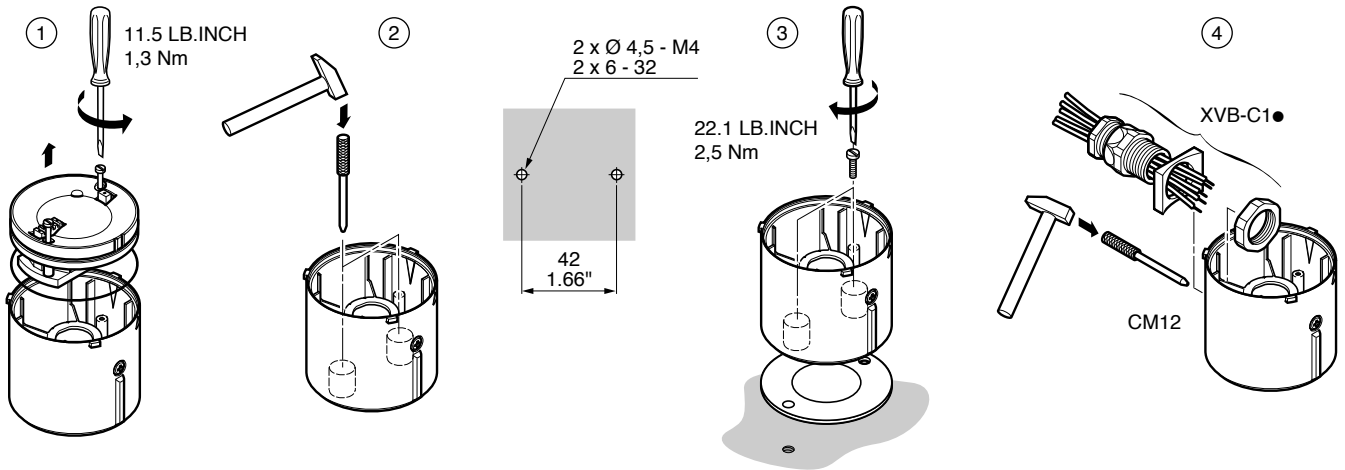

4.4 LB.INCH
0,5 Nm

1 x 0,75 mm² / # 19 AWG
2 x 1,5 mm² / # 16 AWG
1 x 2,5 mm² / # 14 AWG

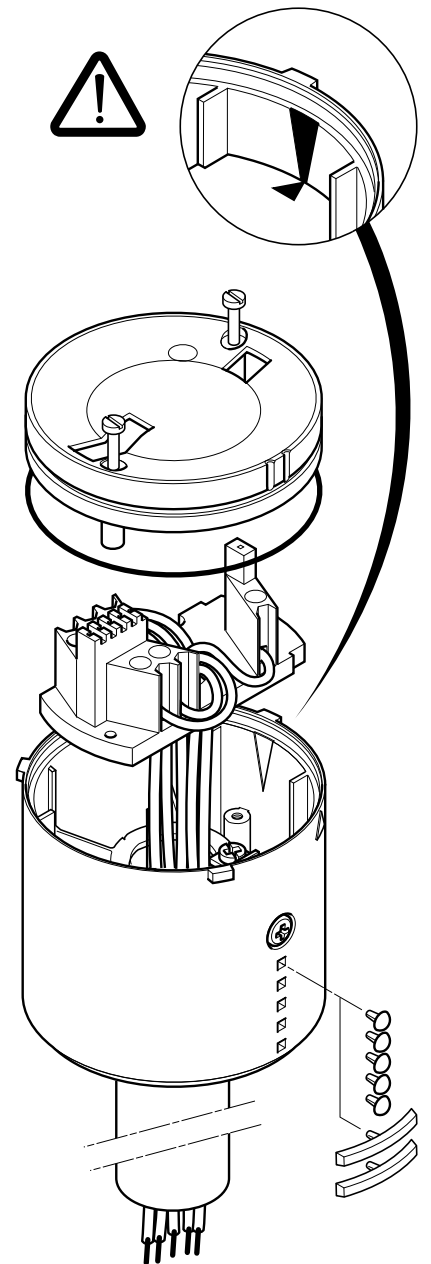
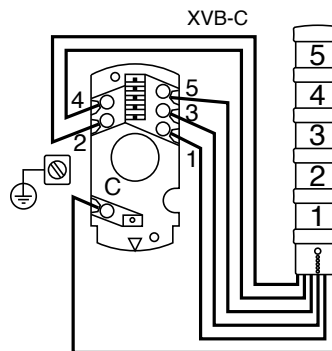
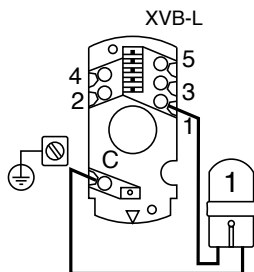

1 INCH = 25,4 mm

 HAZARDOUS VOLTAGE / PELIGRO / DANGER / LEBENSGEFAHR! / PERICOLO / PERIGO		
HAZARDOUS VOLTAGE Disconnect all power before servicing equipment. Electric shock will result in death or serious injury.	TENSION DANGEREUSE Coupez l'alimentation avant de travailler sur cet appareil. Une électrocution entraînera la mort ou des blessures graves.	TENSIONE PERICOLOSA Interrompere l'alimentazione prima di operare su quest'apparecchio. Una scossa elettrica può provocare la morte o ferite gravi.
TENSION PELIGROSA Desenergice el equipo antes de realizarle servicio. Una descarga eléctrica podrá causar la muerte o lesiones serias.	GEFÄHRLICHE SPANNUNG Alle elektrischen Anschlüsse trennen, bevor Sie an diesem Gerät arbeiten. Ein elektrischer Schlag kann zum Tode führen oder schwere Verletzungen verursachen.	TENSÃO PERIGOSA Cortar a alimentação antes de intervir neste aparelho. Um choque eléctrico ocasionará a morte ou ferimentos graves.

	XVBC3.□ XVBL3.	XVBC4.□ XVBL4.
DL1BK...	OK	—
	XVBC38 XVBL38	XVBC48□ XVBL48
DL1BD.8	—	—
DL1BD.1	OK	OK
DL1BK.8	—	—
DL1BK.1	OK	—

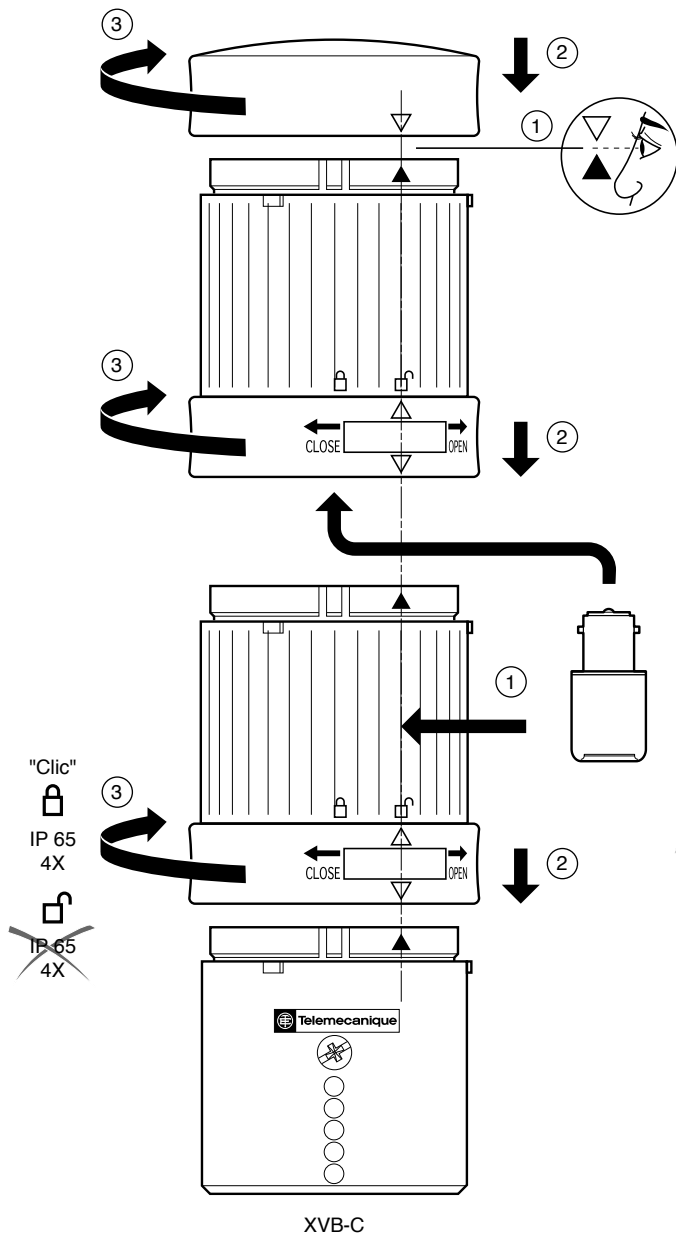

XVB-C

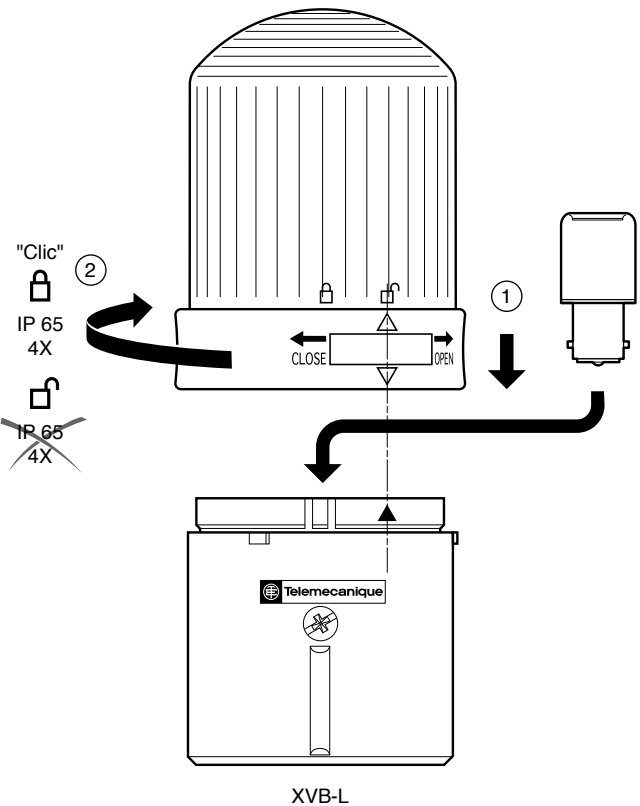
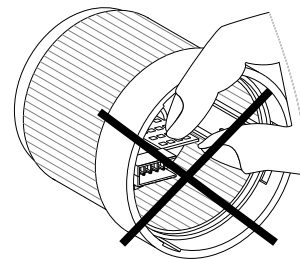

XVB-L

Audible / Zumbador / Buzzer / Summer / Buzzer / Cigarra
XVB-C9•

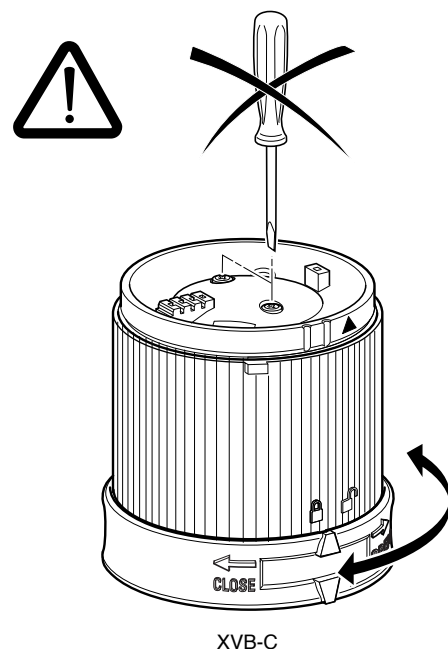
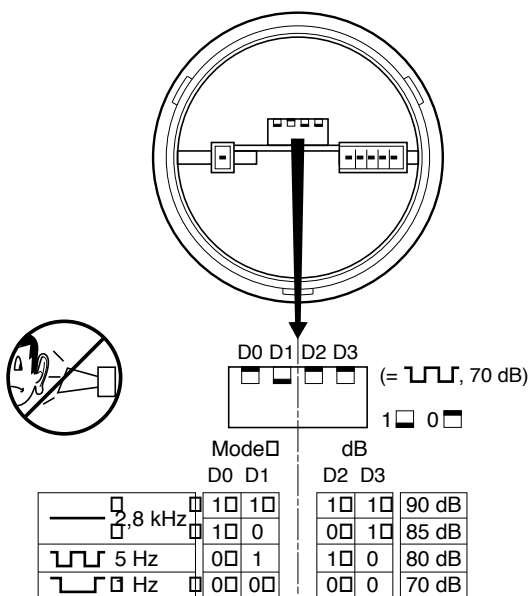

XVB-C